

Measuring Guide Standard



Measuring Instructions (Standard Windows)

How to Measure for Your *Shutters*

SIMPLE STEPS

Tools

Steel tape measure

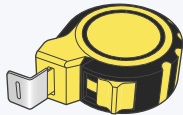

Spirit level



Pencil



Notepad



Golden Rule: Measure twice – order once.



Units: Always use millimetres (mm) for all measurements.



Safety: Keep children and pets clear while measuring.

Step 1 – Choose mounting style

1.1. Inside Mount:

Shutters fit neatly inside the recess.

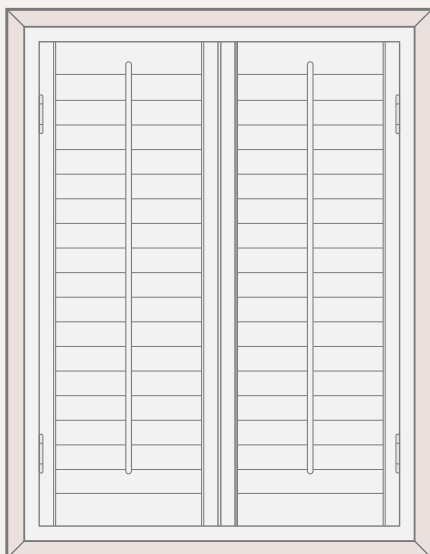

1.2. Outside Mount:

Shutters sit on the wall or frame, covering the whole opening.

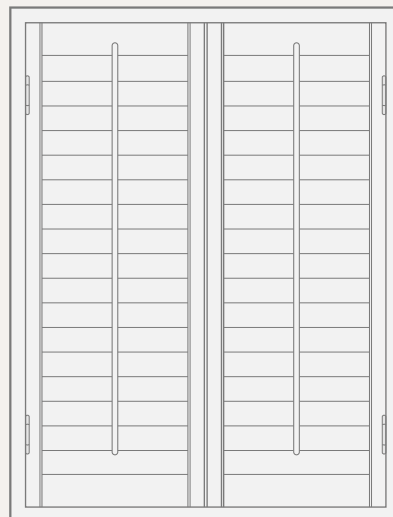

Step 2 – Frame types

2.1. L-Frame:

For inside or outside mounts (flat to the wall)

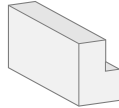

2.2. Z-Frame:

For inside mounts only (wraps around the recess edge, hides gaps)

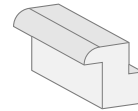

Step 3 – Measure width

3.1. Measure inside the recess at top, middle, and bottom

3.2. Record the smallest measurement

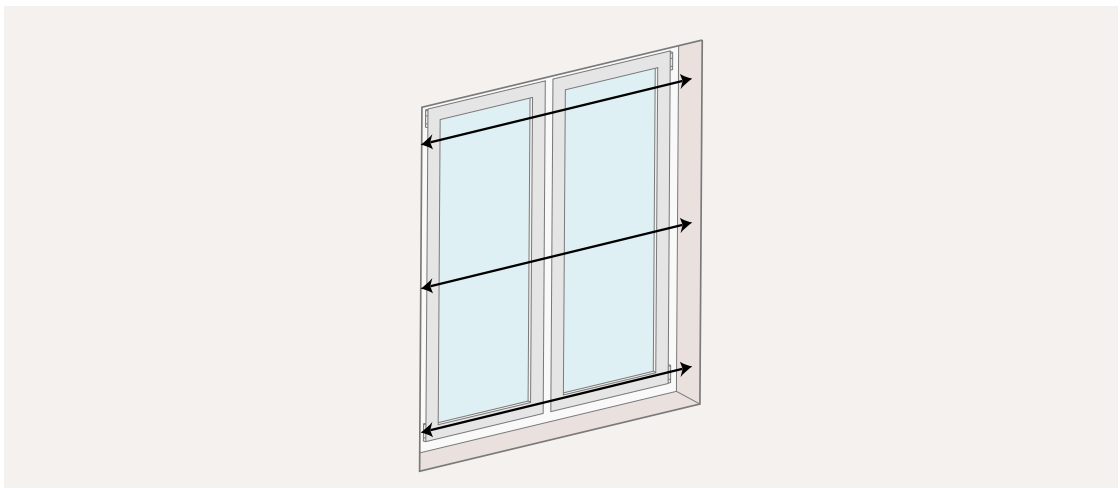

Step 4 – Measure height

4.1. Measure inside the recess at left, centre, and right

4.2. Record the smallest measurement

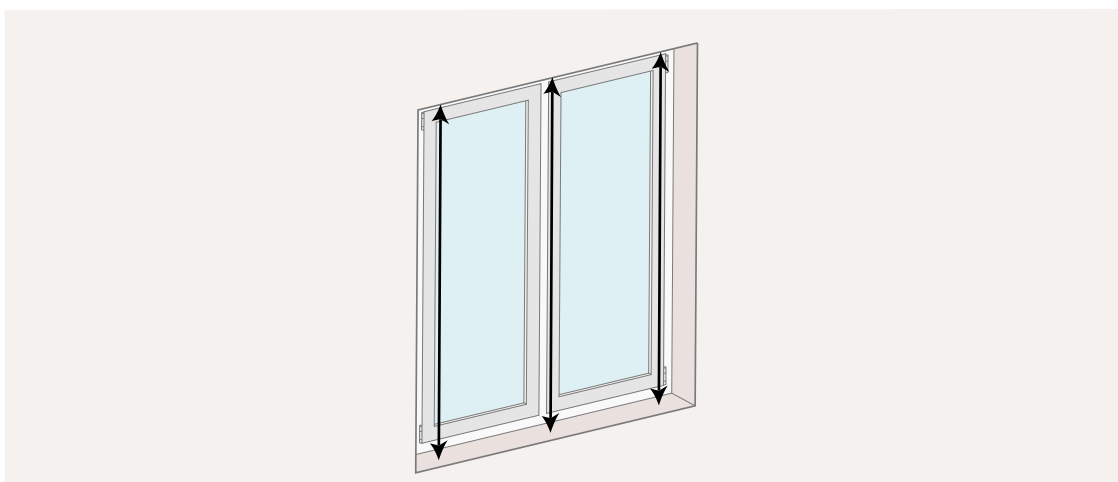

Step 5 – Check recess depth

5.1. Minimum Recess Depth for Louvres

Louvre Size	Minimum Recess Depth
64 mm	60 mm
76 mm	70 mm
89 mm	75 mm
114 mm	85 mm

Step 6 – Mid-Rail (Divider Rail) rules

6.1. If window height is over 1 500 mm: include one mid-rail

6.2. If window height is over 2 500 mm: include two mid-rails

How to measure mid-rail position:

6.3. One rail: measure from sill to centre of mid-rail

6.4. Two rails: measure from sill to centre of Rail 1, then sill to centre of Rail 2

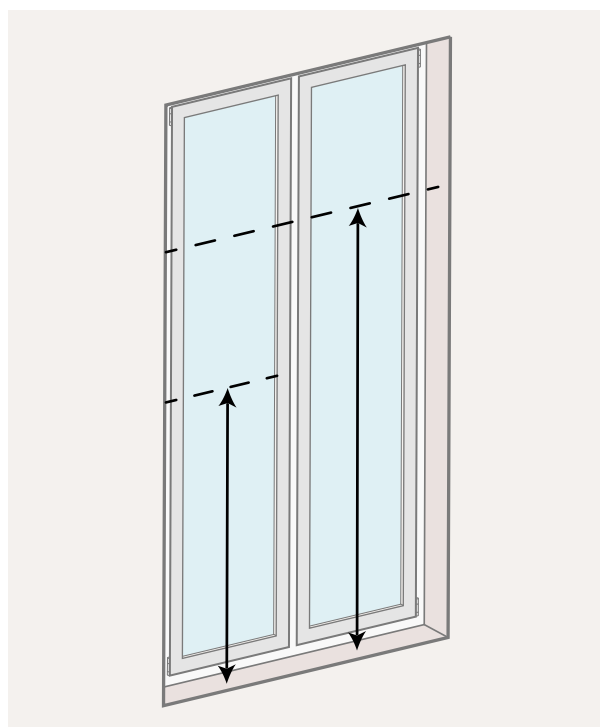
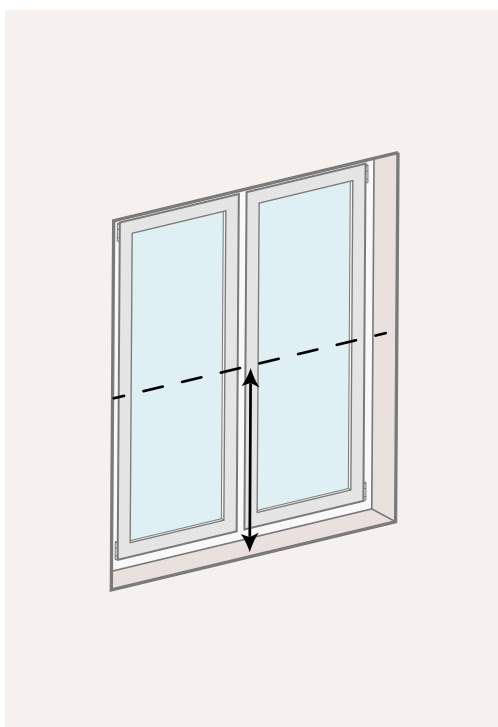

Step 7 – Style options & extra measurements

7.1. Full Height: Panels cover the whole window

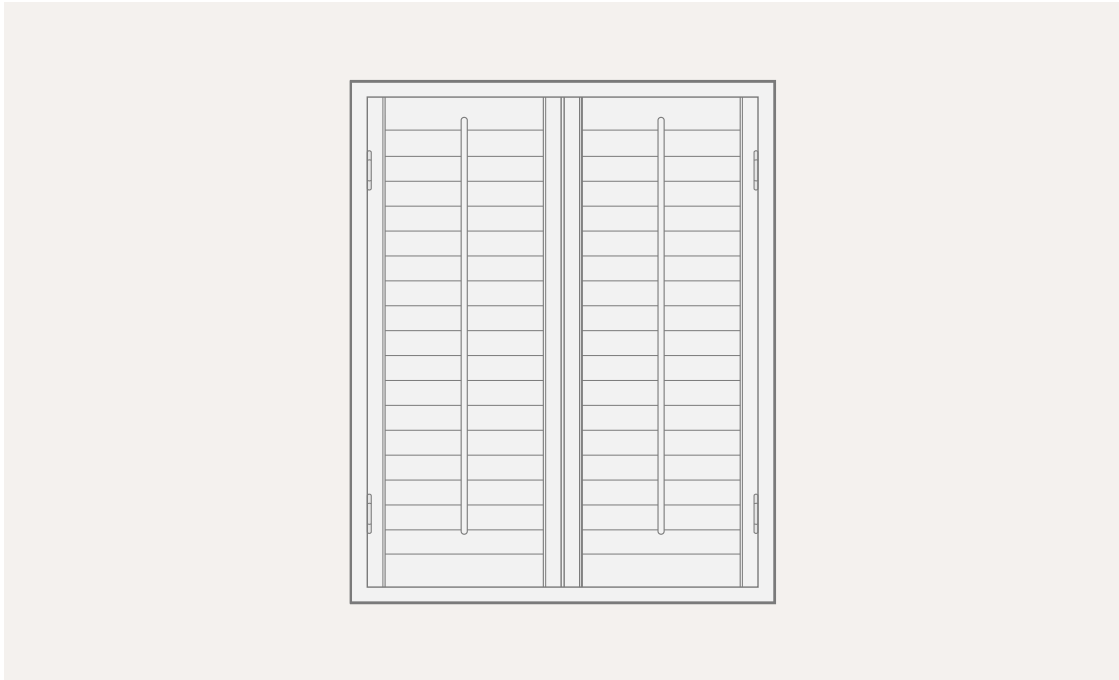

7.2. Tier-on-Tier: Two independent sets – top and bottom



7.3. Extra measurement: Measure from the bottom of the window to the centre of the join between the two sets of panels.

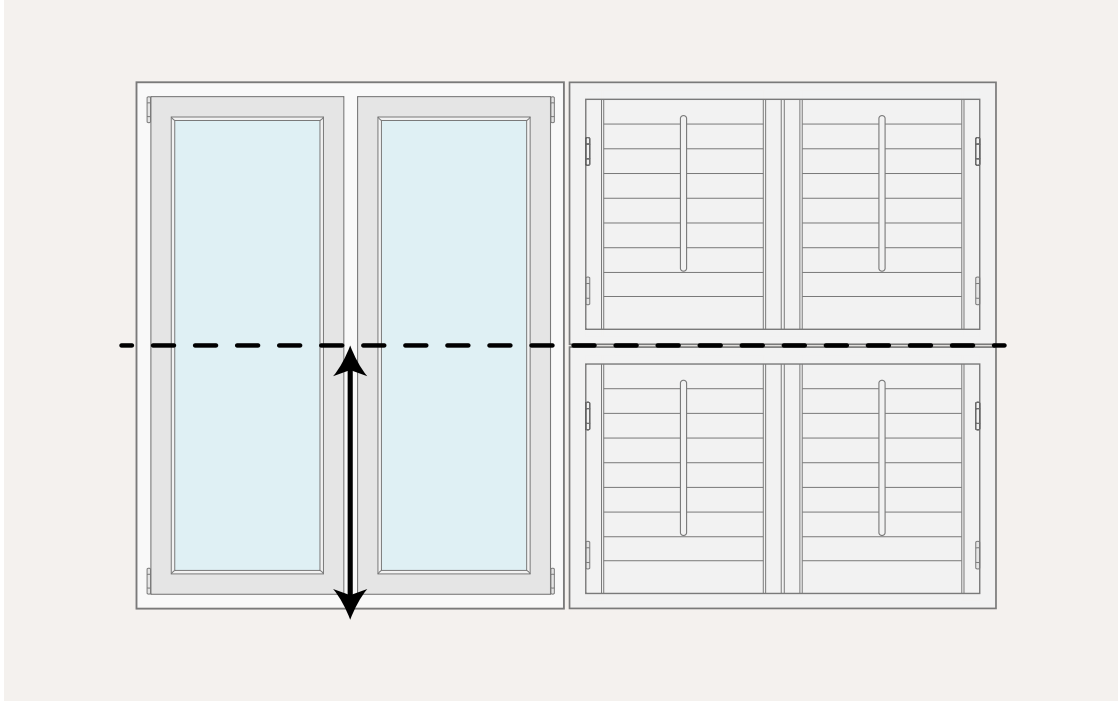

7.4. Café Style: Shutters cover only the lower portion.

7.5. Extra measurement: Measure from the bottom of the window up to the height where you want the café shutters to stop.

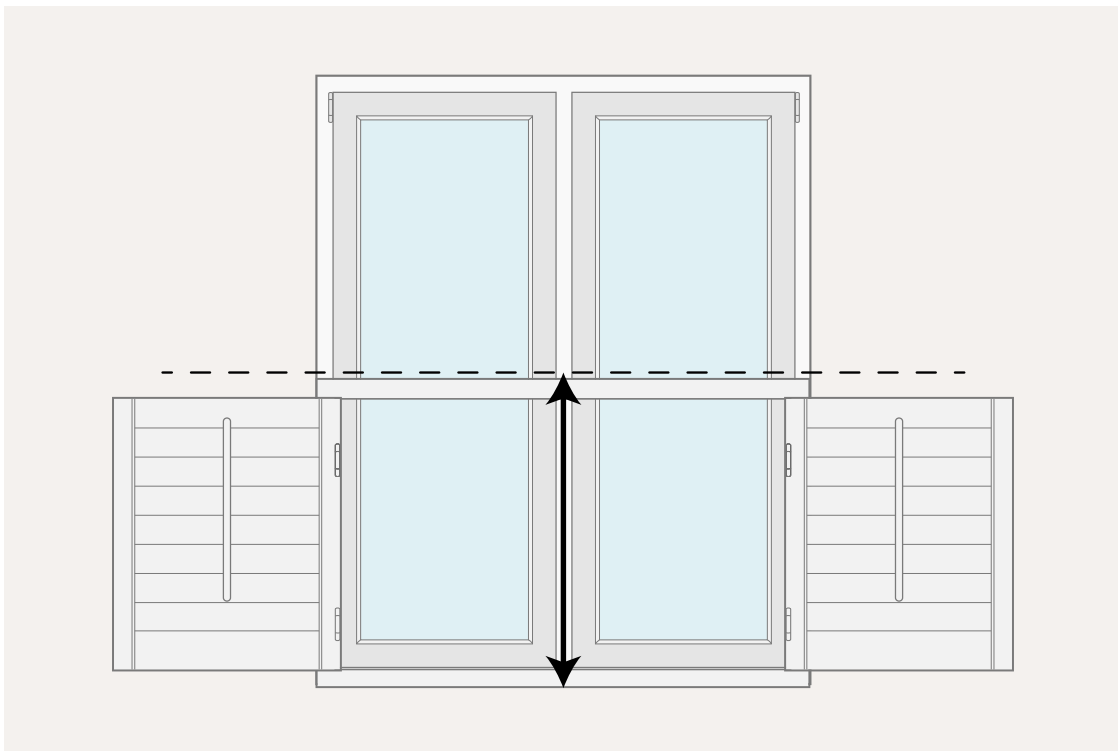

Step 8 – Check the window is square

- 8.1. Measure both diagonals (corner to opposite corner)
- 8.2. If the difference is 5 mm or less, the window is square
- 8.3. If the difference is more than 5 mm, consider an outside mount

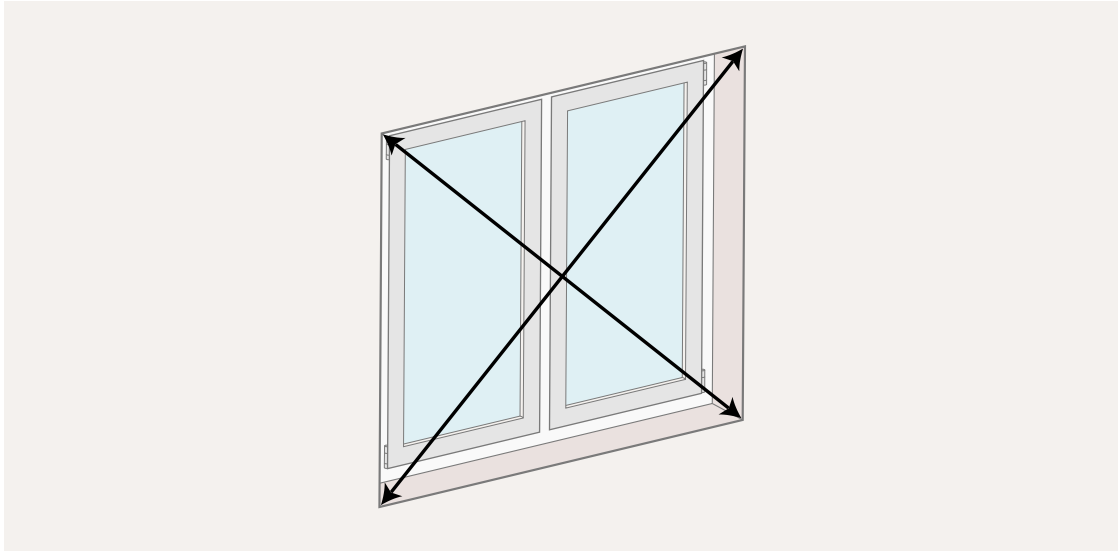

Step 9 – Outside mount measuring

- 9.1. Measure the overall area to cover (width and height)
- 9.2. Add 40 mm each side so the frame overlaps nicely

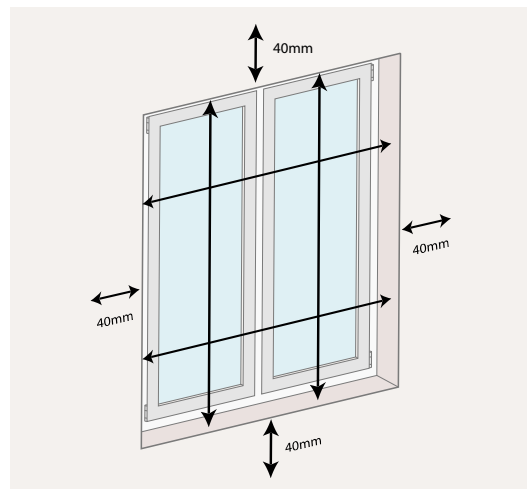
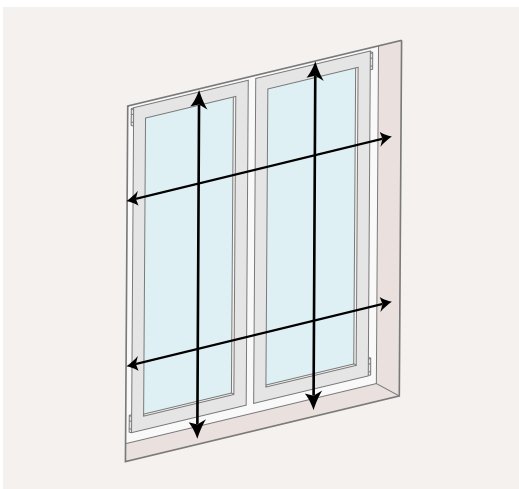

Step 10 – Final Notes

- 10.1. Record all sizes in millimetres
- 10.2. Provide measurements exactly as taken – no deductions
- 10.3. Always record to the nearest millimetre; do not round fractions up or down